



Canterbury Road, Densole, Folkestone

Guide Price £335,000 Freehold

2 bedroom semi-detached house for sale

Description

"Obsidian House" This Two Bedroom Semi-Detached Eco House is ideally located in the village of Densole, near Folkestone and is built and designed to a very high standard. This property is ready to move straight into and has plenty of kerb appeal with lead finished windows and high quality fixtures and fittings. There is a luxury integrated kitchen/breakfast room at the front of the property, this comes complete with an oven, hob, dishwasher, there are high quality units and work surfaces. There is a large lounge/diner in this property with French doors leading out onto the patio and garden, plenty of space for a couple or small family to enjoy ample living space. There is also a good sized hallway with large storage cupboard and a downstairs WC. Upstairs there are two double bedrooms, both with feature bay windows and a luxury family bathroom. Outside this property has two car parking right outside the front door and side access, there is a landscaped rear garden with a patio, lawn and a raised bed, there is a fenced surround.
VIEWING ADVISED

Council Tax Band: C

Tenure: Freehold

Tenure

Freehold



Ground Floor

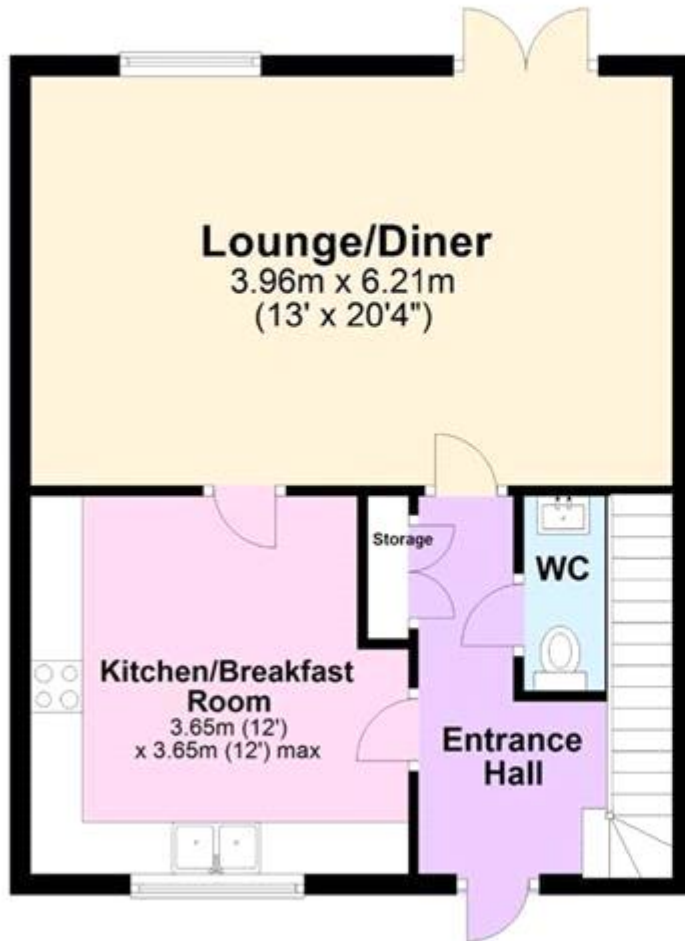

First Floor

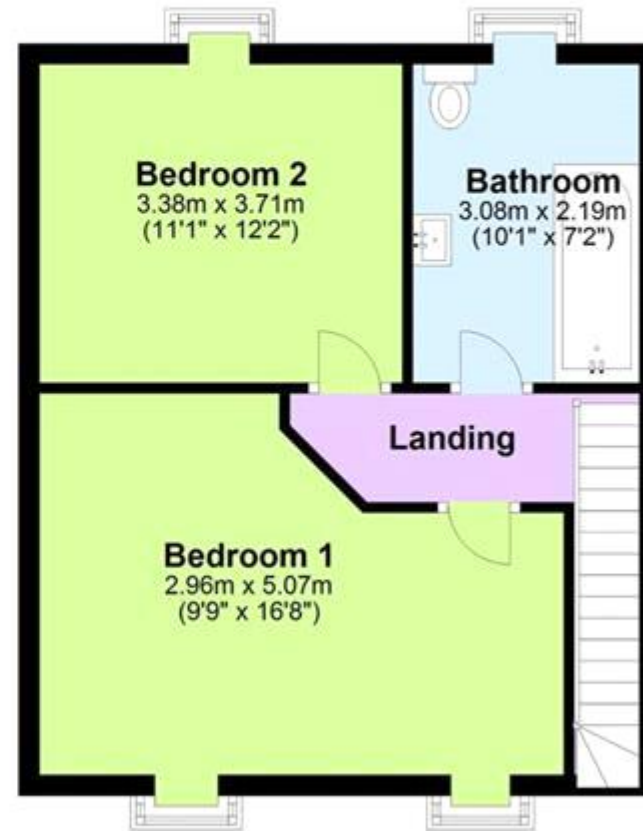



Viewing by appointment only
Oatley & O'Connor Ltd - Head Office
Oatley & O'Connor, 27 Castle Street, Canterbury, Kent CT1 2PX
Tel: 01227 903156 Email: james@oatleyandoconnor.com Website:
<https://oatleyandoconnor.com/>

