



# The Limes, Kingsnorth, Ashford

Guide Price £240,000 Freehold

2 bedroom terraced house for sale

## Description

This Two Bedroom Modern Terraced House is ideally situated in a quiet modern development in the popular location of Kingsnorth in Ashford. This property is ready for the new owners to move straight in with a modern fitted kitchen and neutral modern decoration throughout this great house. As soon as you pull up outside, you can see it's a nice quiet area, there is a play area for children and lots of green spaces surrounding the houses. This property has a driveway at the front, which provides parking for 2 cars, there is also space for your wheelie bins and a useful storage shed here. As soon as you enter, you will feel instantly at home, there is a modern bright hallway with wooden floors and under floor heating, this leads through to a good sized living room, again with wooden floors and under floor heating and French Doors leading out onto the garden, the kitchen is at the front of the house and is finished with white soft close cupboards and granite effect work surfaces, there are also some integrated appliances too. Upstairs, this property has two good sized bedrooms and a modern family bathroom, with a shower over the bath. Outside there is a great rear garden, there is a paved patio and lawned area leading to a garden shed and additional seating area. Viewing of this lovely modern home is highly recommended.

Tenure: Freehold

## Tenure





## Ground Floor

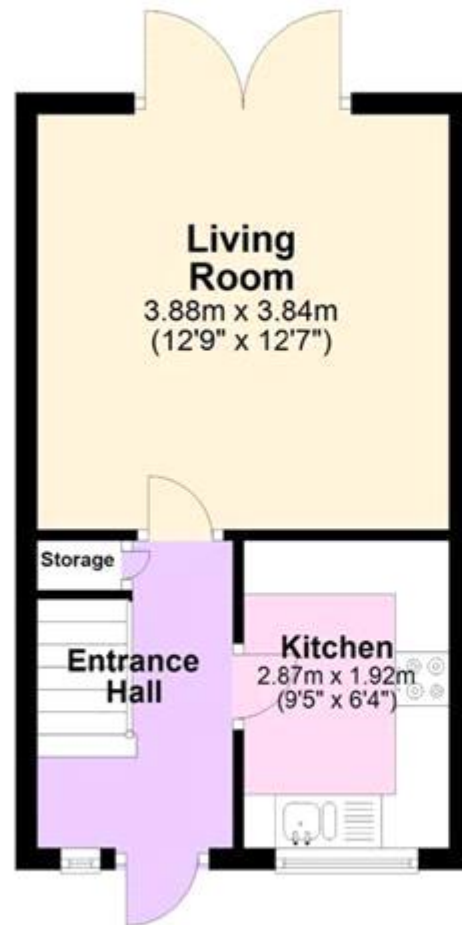

## First Floor

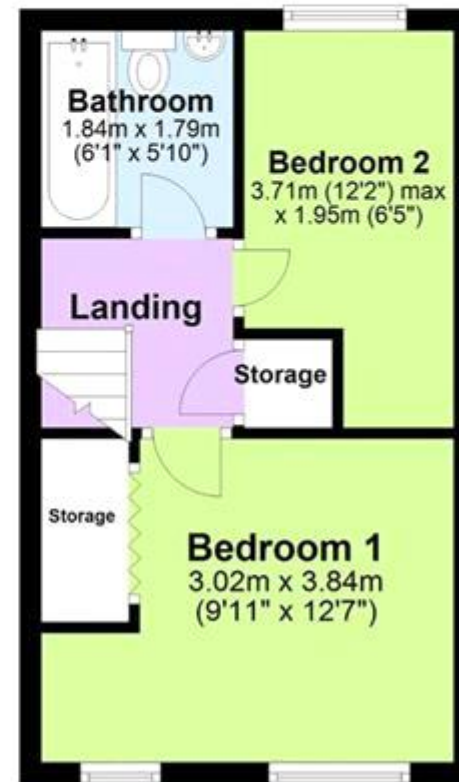



Energy Efficiency Rating		
	Current	Potential
Very energy efficient - lower running costs		
(92-100) <b>A</b>		
(81-91) <b>B</b>		<b>87</b>
(69-80) <b>C</b>	<b>69</b>	
(55-68) <b>D</b>		
(39-54) <b>E</b>		
(21-38) <b>F</b>		
(1-20) <b>G</b>		

Viewing by appointment only  
 Oatley & O'Connor Ltd - Head Office  
 Oatley & O'Connor, 27 Castle Street, Canterbury, Kent CT1 2PX  
 Tel: 01227 903156 Email: [james@oatleyandoconnor.com](mailto:james@oatleyandoconnor.com) Website:  
<https://oatleyandoconnor.com/>

