



Coniston Drive, Aylesham, Canterbury

Guide Price £240,000 Freehold

2 bedroom semi-detached house for sale

Description

Be Quick to View! This Two Bedroom Semi-Detached House is offered for sale with NO CHAIN, ideally located in a quiet cul-de-sac in the popular village of Aylesham in Kent. This property would make a great first time purchase and would also be a great investment too for buy to let, the location is excellent, within a short walk of the village centre with it's parade of local shops and take away outlets, you can also easily walk to the village primary school. There are plenty of countryside walks that can be enjoyed nearby and some playing fields and parks too, the property is within easy access for the A2 for commuting and has a railway station for travel to Canterbury, Dover and London.

As soon as you pull up outside property, you are sure to be impressed, there is a front garden with some grass and trees, that provide good privacy to the property and a porch as an entrance. Once inside, you will feel instantly at home, the bright and spacious lounge/diner is full of natural light, with white plastered walls and wooden flooring, this leads to a fitted kitchen at the rear with a range of units and some appliances, this overlooks the good sized garden. This property also benefits from a conservatory, which a great additional space to this cracking home. Upstairs there are two good sized bedrooms and a modern family bathroom with a three piece white suite. Outside to the rear is a suntrap garden with a paved patio perfect for sunbathing and barbeques, there is side access and a small shed too, the side gate leads out to the rear, where you have your own driveway with parking for at least two



cars. VIEWING HIGHLY RECOMMENDED

Tenure: Freehold

Tenure

Freehold

Ground Floor

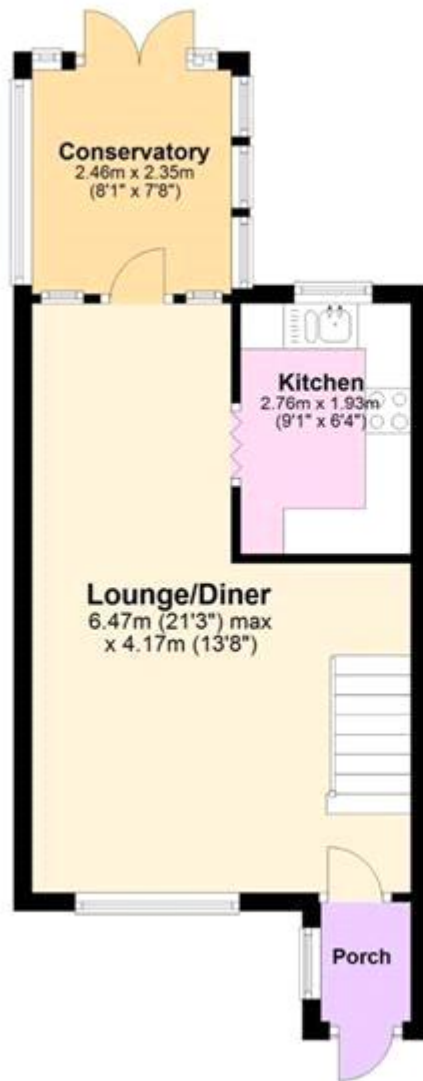

First Floor

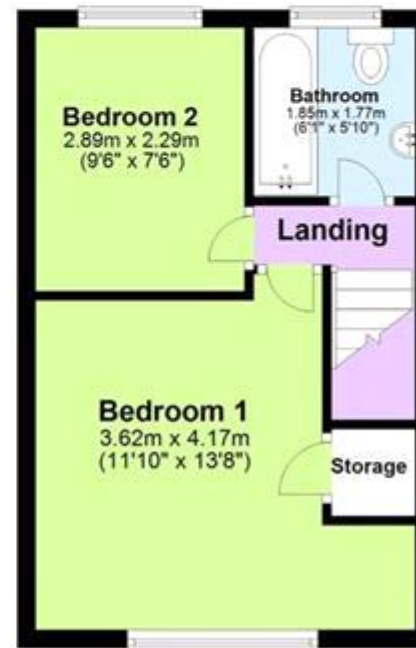



Energy Efficiency Rating		
	Current	Potential
Very energy efficient - lower running costs		
(92-100) A		
(81-91) B		88
(69-80) C	70	
(55-68) D		
(39-54) E		
(21-38) F		
(1-20) G		

Viewing by appointment only
 Oatley & O'Connor Ltd - Head Office
 Oatley & O'Connor, 27 Castle Street, Canterbury, Kent CT1 2PX
 Tel: 01227 903156 Email: james@oatleyandoconnor.com Website:
<https://oatleyandoconnor.com/>

