



---

# Meridian Close, Ramsgate

Guide Price £269,995 Freehold

2 bedroom terraced house for sale

---

## Description

Be Quick to view this Two Bedroom Modern Terraced House, which is ideally located in a popular part of the seaside town of Ramsgate. This property is ideal for first time buyers, downsizers or investors, there is a Tesco supermarket within easy walking distance of the property, as well as good local schools and other amenities. The town centre, shops and seafront are only a short distance away. This location is quiet and well maintained, the property is surrounded by a block-paved cul-de-sac where you can park easily in the allocated space, this property also has a driveway which can fit on one small car or motorbike.

Once inside you will find a well maintained modern property, the hallway is neutrally decorated and there is a ground floor WC which is ideal for day to day life. The kitchen has a great range of modern units and integrated appliances, there are granite effect surfaces and it's sunny and bright. The main lounge/diner is at the rear of the property and is nice and spacious, there is plenty of room in here for both living and dining, this property also benefits from a conservatory, which is a very useful extra space and overlooks the garden.

Upstairs there are two double bedrooms, the main bedroom has an En-Suite shower room and there is a modern three piece family bathroom too. Outside there is a lovely sunny rear garden, with a patio and artificial grass, so nice and easy to maintain, there is also rear access and a shed. EARLY VIEWING RECOMMENDED



Tenure: Freehold

**Tenure**

Freehold



### Ground Floor

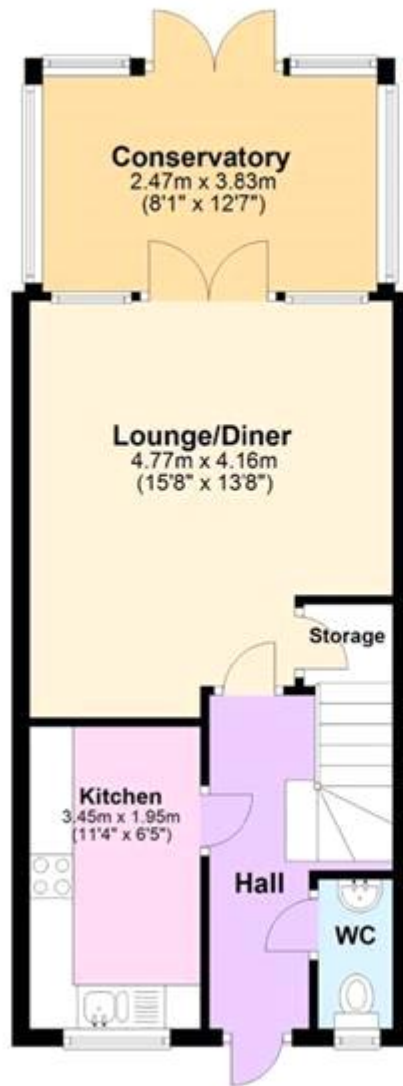

### First Floor





Viewing by appointment only  
Oatley & O'Connor Ltd - Head Office  
Oatley & O'Connor, 27 Castle Street, Canterbury, Kent CT1 2PX  
Tel: 01227 903156 Email: [james@oatleyandoconnor.com](mailto:james@oatleyandoconnor.com) Website:  
<https://oatleyandoconnor.com/>

