



Osborne Road, Willesborough, Ashford

Guide Price £375,000 Freehold

3 bedroom semi-detached house for sale

Description

This Three Bedroom Semi-Detached House is ideally located in Willesborough, within walking distance of Ashford Town Centre, there are several good local schools nearby and plenty of shops, bars and restaurants within easy reach of the property, making it the perfect family home. As soon as you pull up outside, you are sure to be impressed, there is a large driveway, this provides parking for at least three cars and there is a carport to the side of the house providing extra storage space.

Once inside you will find a large entrance hallway, this has been made larger by the current owners and provides a great start to the viewing. The living room has been knocked through into one large open plan space, perfect for modern life and providing a sociable space that a family can enjoy. The kitchen has also been extended to the rear, making for a great sized modern kitchen/diner with a good range of units and complimentary work surfaces, the footings in the extension also are strong enough for two storeys, so there's loads of potential for the future too. Upstairs there are three bedrooms, two good sized doubles and a well fitted three piece white family bathroom.

Outside is absolutely fantastic, there is a huge South Westerly facing rear garden, a large sun patio with plenty of room for outside dining and entertaining and two large lawned areas with a range of plants, shrubs and trees, there are also two large outbuildings again providing a party area and more storage.

VIEWING IS HIGHLY RECOMMENDED



Tenure

Freehold

Ground Floor

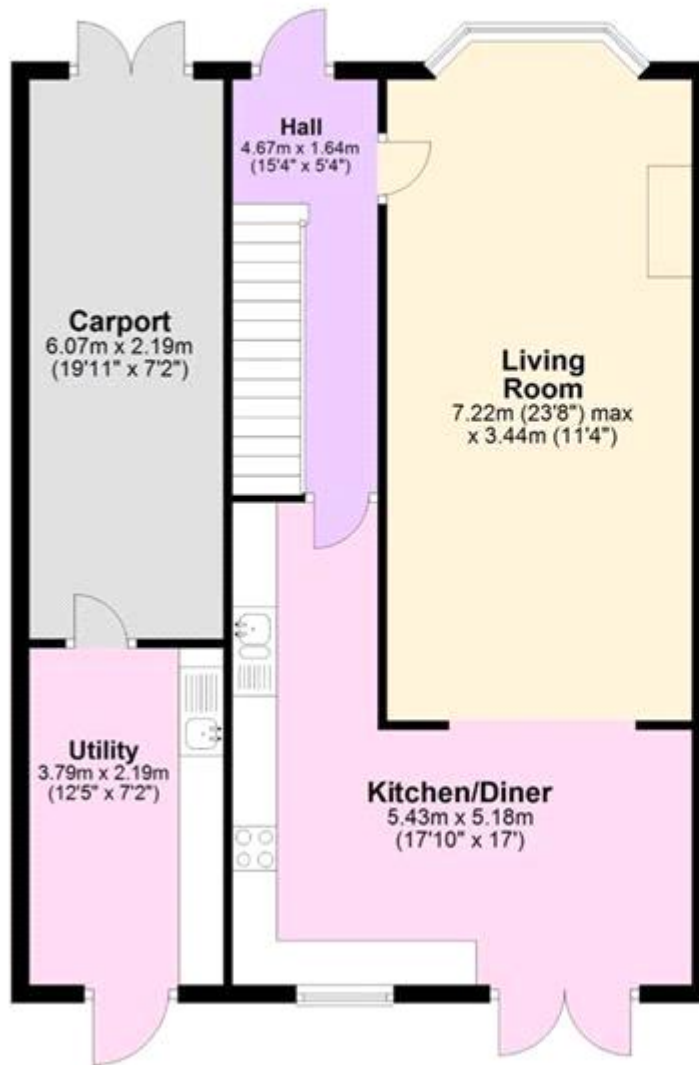

First Floor





Viewing by appointment only
Oatley & O'Connor Ltd - Head Office
Oatley & O'Connor, 27 Castle Street, Canterbury, Kent CT1 2PX
Tel: 01227 903156 Email: james@oatleyandoconnor.com Website:
<https://oatleyandoconnor.com/>

