



ALBION ROAD

# Gore Lane, Eastry, Sandwich

Guide Price £210,000 Leasehold

2 bedroom maisonette for sale

## Description

This Two Bedroom Upper Floor Maisonette is located in the Kentish village of Eastry, the perfect place for young first time buyers and retiring couples. The village has a wealth of amenities, this includes the popular Five Bells Pub with its traditional English Fayre and selection of Ales, the local Post Office which is open 7 days a week, a doctors surgery, local convenience store, a Chinese take away, Fish Bar and a pharmacy. There are also some lovely walks and countryside to be enjoyed nearby, ideal for dog walkers and pets. This property has been well maintained and comes complete with a large sunny lawned rear garden, there is also a decked patio, a great range of plants, shrubs and trees and the essential garden shed, the property also has a brick built outhouse too so there's no shortage of storage space. The property has a block-paved driveway too, which provides off road parking for one car.

You enter on the ground floor, there is a sunny entrance hall with a tiled floor and another large storage cupboard.

Upstairs you will find the rest of the property, this includes a well fitted kitchen with a good range of units, a large lounge with wooden flooring and a sunny aspect, two double bedrooms and a well fitted family bathroom with a bath and shower over, feature glass tiled shower screen and a slate effect tiled floor.

The property is for sale with NO CHAIN and VIEWING IS HIGHLY RECOMMENDED



## Tenure



### Ground Floor

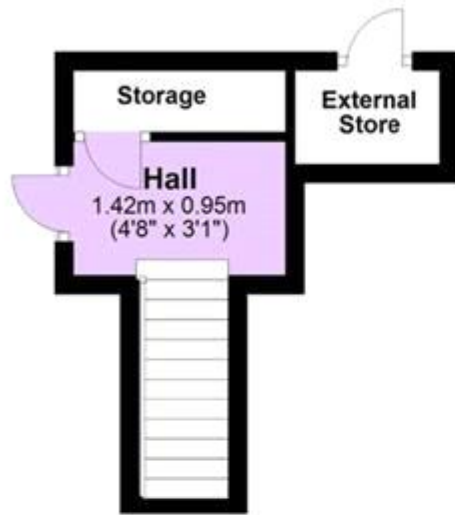

### First Floor





Energy Efficiency Rating		
	Current	Potential
Very energy efficient - lower running costs		
(92-100) <b>A</b>		
(81-91) <b>B</b>		
(69-80) <b>C</b>	74	79
(55-68) <b>D</b>		
(39-54) <b>E</b>		
(21-38) <b>F</b>		
(1-20) <b>G</b>		

Viewing by appointment only  
 Oatley & O'Connor Ltd - Head Office  
 Oatley & O'Connor, 27 Castle Street, Canterbury, Kent CT1 2PX  
 Tel: 01227 903156 Email: [james@oatleyandoconnor.com](mailto:james@oatleyandoconnor.com) Website:  
<https://oatleyandoconnor.com/>

