



Lower Queens Road, Ashford

Guide Price £525,000 Freehold

Period Semi with Huge Garden

Description

Ideally located in a quiet tree lined road in Ashford Town Centre is this lovely four bedroom period home. Perfect for access to the town centre, with its array of shops, bars and restaurants, as well as within easy walking distance of Ashford International Railway Station. Once inside this property, you will not be disappointed, there is large living room, with extended family space with skylight windows and French doors out on to the garden. There is also a modern kitchen/breakfast room which has a range of appliances and is flooded with natural light. There are four double bedrooms in the property, all of these have fitted wardrobes and a spacious four piece luxury family bathroom with walk in double shower. Outside this property is fabulous, there is a huge mature garden which has an abundance of lawned space for a family to enjoy, the house has several sheds and side access, the garden is full of colourful plants and shrubs. VIEWING HIGHLY RECOMMENDED

Tenure

Freehold



Ground Floor



First Floor

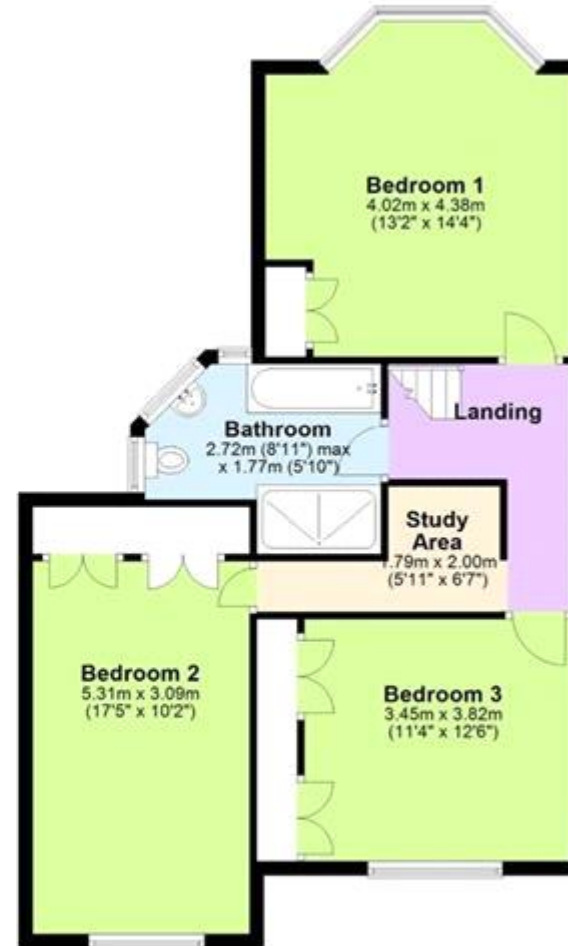



Viewing by appointment only
Oatley & O'Connor Ltd - Head Office
Oatley & O'Connor, 27 Castle Street, Canterbury, Kent CT1 2PX
Tel: 01227 903156 Email: james@oatleyandconnor.com Website:
<https://oatleyandconnor.com/>

