



Hythe Road, Willesborough, Ashford

£385,000 Freehold

EXTENDED 1930'S SEMI

Description

This extended 1930's Semi-Detached family home is presented in first class condition and is ready to move straight into. Ideally located in Willesborough near Ashford, within easy reach of the town centre and international station. This fantastic property benefits from a large modern family kitchen with a great range of fitted units and a range cooker, there is loads of natural light in this room with French doors opening out onto the garden. There are two separate reception rooms, the living room has a large bay window and feature fireplace and the dining area has plenty of space for family meals or entertaining guests. The house also has a utility room and downstairs cloakroom making it the perfect family home. Upstairs there are three good sized bedrooms and a modern family bathroom with a three piece white suite, P-Shaped bath and shower over. Outside there is a large front garden with a colourful range of plants and shrubs and large lawn, there is a walled frontage and wrought iron gate for entrance. At the rear is a good sized, sunny family garden with a patio and lawn, there is access to the driveway and garage from here too. VIEWING HIGHLY RECOMMENDED

Tenure

Freehold



Ground Floor



First Floor

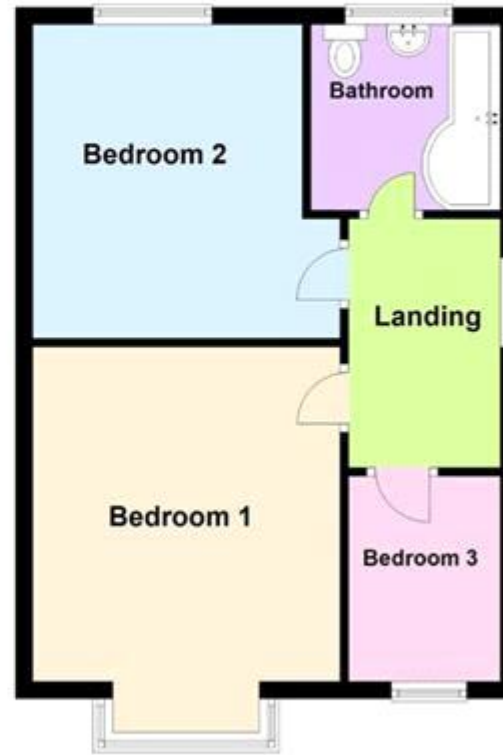



Energy Efficiency Rating		
	Current	Potential
Very energy efficient - lower running costs		
(92-100) A		
(81-91) B		
(69-80) C		82
(55-68) D	70	
(39-54) E		
(21-38) F		
(1-20) G		

Viewing by appointment only
 Oatley & O'Connor Ltd - Head Office
 27 Castle Street, Canterbury, Kent CT1 2PX
 Tel: 01227 903156 Email: jamesoatley@yahoo.co.uk Website: <https://oatleyandoconnor.com/>

